

WELDED OUTLET

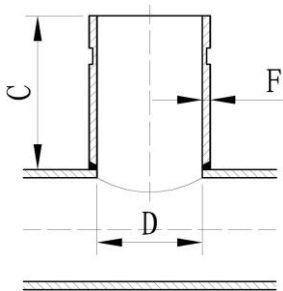

WG01 Welded Outlet (Cut Grooved)

- **Size Range:** 1 1/4" Through 6" Outlet
- **Material:** Carbon Steel
- **Connections:** Cut Grooved
- **UL/ULC Listed**



Outlet Size			Dimensions					Wt.
Nominal Size	O.D.	Header Size	C	D	F			
NPS	DN	mm	NPS	DN	mm	mm	kg	
1 1/4"	32	42.4	1 1/4"	32	76	35	3.6	0.26
			1 1/2"	40	76	35	3.6	0.26
			2"	50	76	35	3.6	0.26
			2 1/2"	65	76	35	3.6	0.26
			3"~4"	80~100	76	35	3.6	0.25
			5"~8"	125~200	76	35	3.6	0.25
1 1/2"	40	48.3	1 1/2"	40	76	41	3.6	0.30
			2"	50	76	41	3.6	0.30
			2 1/2"	65	76	41	3.6	0.30
			3"~4"	80~100	76	41	3.6	0.29
			5"~8"	125~200	76	41	3.6	0.29
2"	50	60.3	2"	50	76	53	3.9	0.44
			2 1/2"	65	76	53	3.9	0.44
			3"	80	76	53	3.9	0.43
			4"	100	76	53	3.9	0.43
			5"	125	76	53	3.9	0.43
			6"	150	76	53	3.9	0.42
			8"	200	76	53	3.9	0.42
2 1/2"	65	73.0/76.1	2 1/2"	65	76	64/67	4.5	0.70
			3"	80	76	64/67	4.5	0.70
			4"	100	76	64/67	4.5	0.70
			5"	125	76	64/67	4.5	0.70
			6"	150	76	64/67	4.5	0.70
			8"	200	76	64/67	4.5	0.70
3"	80	88.9	3"	80	76	78	5.5	0.89
			4"	100	76	78	5.5	0.89
			5"	125	76	78	5.5	0.89
			6"	150	76	78	5.5	0.86
			8"	200	76	78	5.5	0.86
4"	100	114.3	4"	100	102	102	6.0	1.85
			5"	125	102	102	6.0	1.85
			6"	150	102	102	6.0	1.74
			8"	200	102	102	6.0	1.71
6"	150	165.1/168.3	6"	150	102	151/154	7.0	3.2
			8"	200	102	151/154	7.0	3.2