

## C1 - Cross (Standard Radius)

- ◆ NPS1" (DN25) through NPS12" (DN300)
- ◆ Material : ASTM A536 Gr. 65-45-12
- ◆ Cut groove dimension according: ANSI/AWWA C606
- ◆ Finish : Epoxy Coatings in RAL3000 red, available with hot dipped galvanized finish or orange painted.



### Dimension

Nominal Size	Pipe O.D	Max. Work Pressure	CE	Weight kg / lbs
DN / NPS	mm / in	MPa / psi	mm / in	
25	33.4	2.07	57	0.65
1"	1.315	300	2.24	1.43
32	42.2	2.07	70	0.9
1 1/4"	1.660	300	2.76	1.98
40	48.3	2.07	70	0.95
1 1/2"	1.900	300	2.76	2.09
50	60.3	2.07	83	1.2
				2.65
2"	2.375	300	3.27	
65	73.0	2.07	95	1.7
2 1/2"	2.875	300	3.74	3.75
65	76.1	2.07	95	1.8
3" O.D	3.000	300	3.74	3.97
80	88.9	2.07	108	2.4
3"	3.500	300	4.25	5.29
100	114.3	2.07	127	4.2
4"	4.500	300	5.00	9.26
125	139.7	2.07	140	6.0

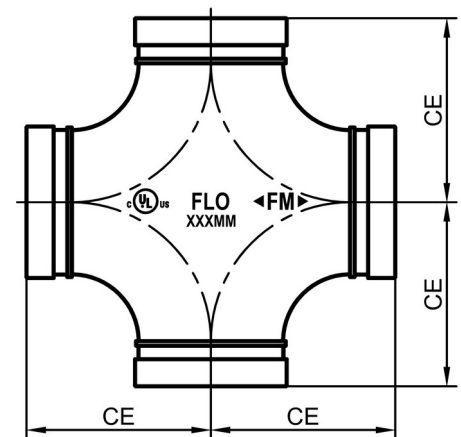
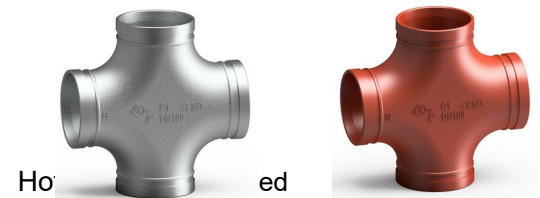

5 <sup>1</sup> / <sub>2</sub> "O.D	5.500	300	5.51	13.23
125	141.3	2.07	140	6.1
5"	5.563	300	5.51	13.45
150	165.1	2.07	165	9.8
6 <sup>1</sup> / <sub>2</sub> "O.D	6.500	300	6.50	21.61
150	168.3	2.07	165	9.9
6"	6.625	300	6.50	21.83
200	219.1	2.07	197	18.7
8"	8.625	300	7.76	41.23
250	273.0	2.07	229	29.5
10"	10.750	300	9.02	65.05
300	323.9	2.07	254	42.4
12"	12.750	300	10.00	93.49